

Art. 2.0272

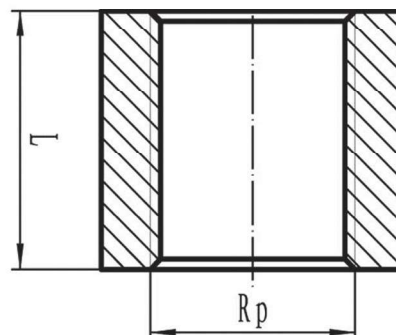

Beschrieb: Halbmuffe
Material: Stahl schwarz DIN EN 10241
Gewindeart: IG-Rp / ISO 7-1

Description: demi-manchon
Matériel: acier noir DIN EN 10241
Filetage: f-Rp / ISO 7-1

2.0272.	013	025	038	050	075	100	125	150	200	300
Rp	1/8"	1/4"	3/8"	1/2"	3/4"	1"	1 1/4"	1 1/2"	2"	3"
L	8	11	12	16	18	22	23	24	27	35
Verpackung / Emballage										
Polybag	50	50	50	50	25	20	10	10	10	1
Box	1000	1000	1000	600	500	300	200	120	100	100