

Art. 8.0310

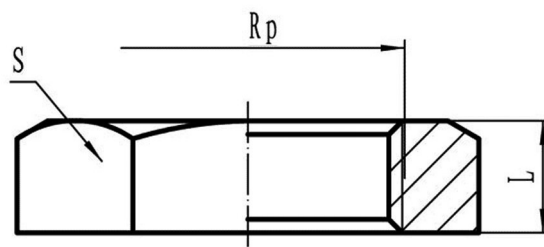

Beschrieb: Kontermutter
Material: Edelstahl AISI 316 - 1.4408
Gewindeart: IG-Rp / ISO 7-1
Bemerkungen: SVGW Wasser 3/8" - 4"
 SVGW Gas 3/4" - 2"

Description: contre-écrou
Matériel: inox AISI 316 - 1.4408
Filetage: f-Rp / ISO 7-1
Remarques: SSIGE Eau 3/8" - 4"
 SSIGE Gaz 3/4" - 2"



| 8.0310. | 025 | 038 | 050 | 075 | 100 | 125 | 150 | 200 |
|-------------------------------|------|------|------|------|-----|--------|--------|-----|
| Rp | 1/4" | 3/8" | 1/2" | 3/4" | 1" | 1 1/4" | 1 1/2" | 2" |
| L | 7 | 8 | 8 | 10 | 11 | 11 | 13 | 14 |
| S | 11 | 24 | 29 | 36 | 41 | 52 | 60 | 70 |
| Verpackung / Emballage | | | | | | | | |
| Polybag | 10 | 10 | 10 | 10 | 10 | 10 | 10 | 5 |